



# SMART POSITIONER YT-1000 SERIES



**YT-1000R**



**YT-1000L**

<b>Housing Material</b>	Aluminum	
<b>Motion Type</b>	Linear	Rotary
<b>Acting Type</b>	Single / Double	
<b>Input Signal</b>	4 - 20 mA DC	
<b>Supply Pressure</b>	0.14 ~ 0.7 Mpa (1.4 ~ 7 bar)	
<b>Stroke</b>	10 ~ 150 mm	0 ~ 90°
<b>Impedance</b>	Máx. 250 ± 15Ω	
<b>Air Connection</b>	PT (G or NPT) 1/4	
<b>Gauge Connection</b>	PT (G or NPT) 1/8	
<b>Conduit Entry</b>	PF (G or NPT) 1/2 or M20	
<b>Ingress Protection</b>	IP66, Type 4X	
<b>Explosion Proof</b>	1. Non-explosion	
	2. Ex db mb IIB T5 Gb (ATEX, IECEx, TS) 3. Ex d IIC T5 (KCs) 4. Ex ia IIB T6 Gb (KCs) 5. Ex d mb IIC T6 Gb (NEPSI) 6. Ex dmb IIB T5 (KCs, TIIS) 7. Ex d m IIB T5 (FM, CSA) 8. Ex d mb IIB T5 GB X (TRCU)	
	Refer to "2.6 certifications" for details	

<b>Ambient Temperature Of Explosion proof</b>		Refer to "2.6 certifications" for details
<b>Operating Temperature</b>	<b>Standard</b>	(-20°C ~ 60°C) -4°F ~ 140°F
	<b>High Temperature</b>	(-20°C ~ 120°C) -4°F ~ 248°F
	<b>Low Temperature</b>	(-40°C ~ 70°C) -40°F ~ 158°F
<b>Linearity</b>	<b>Single</b>	±1% F.S.
	<b>Double</b>	±2% F.S.
<b>Hysteresis</b>		±1% F.S.
<b>Sensitivity</b>	<b>Single</b>	±0.2% F.S.
	<b>Double</b>	±0.5% F.S.
<b>Repeatability</b>		±0.5 F.S.
<b>Flow Capacity</b>		80 LPM (Sup. = 0.14 Mpa)
<b>Air Consumption</b>		2.5 LPM (Sup. = 0.14 Mpa)
<b>Feedback Signal (Option)</b>		4 ~ 20 mA (DC 9 ~ 28 V)
<b>Weight</b>		2.7 Kg (6.1 lb)      2.8 Kg (6.2 lb)
<b>Painting</b>		Epoxy Polyester Powder Coating

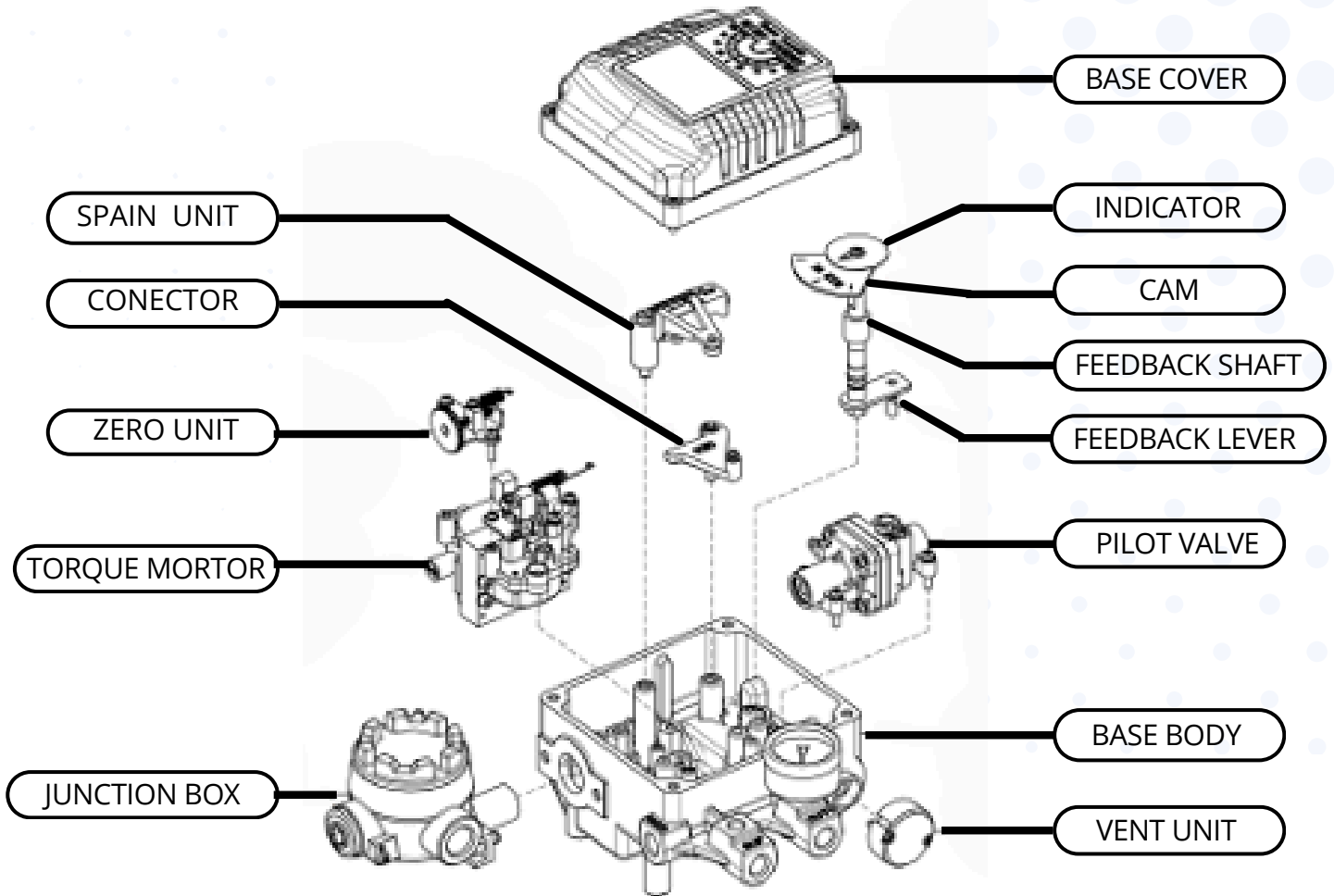

MODEL	MODEL	ACTING TYPE	EXPLOSION PROOF	LEVER TYPE	ORIFICE TYPE	CONDUIT-AIR CONNECTION	OPERATING TEMP *2	OPTION 1	OPTION 2 *2
YT-1000	<b>0</b> L: LINEAL <b>1</b> R: ROTATIVO	<b>S</b> single <b>D</b> Double	<b>N</b> Non-Explosion <b>M</b> ATEX, IECEx, TS, KC <b>A</b> CSA, FM <b>C</b> KC, NEPS <b>I</b> KC <b>X</b> TIIS	<b>1</b> M6 X 34L <b>2</b> M6 X 63L <b>3</b> M8 X 34L <b>4</b> M8 X 63L <b>5</b> NAMUR <b>6</b> M6 X 20L <b>7</b> M5 X 20L	<b>1</b> Low flow <b>2</b> Standard flow <b>3</b> High flow	<b>0</b> NPT 1/2"- NPT 1/2" <b>1</b> G1/2 - NPT1/4 <b>2</b> G1/2 - NPT1/4 <b>3</b> G1/2 - G1/4 <b>4</b> M20 - NPT1/4 *1 <b>5</b> NPT1/2 - NPT1/4	<b>S</b> -20°C ~ 60°C <b>H</b> -20°C ~ 120°C <b>L</b> -40°C ~ 70°C	<b>0</b> NONE (St'd) <b>1</b> Dome Cove	<b>0</b> NONE <b>1</b> + SPTM(Internal) <b>2</b> + SPTM(External) <b>3</b> + L/S(Internal) <b>4</b> + L/S(External) <b>5</b> + SPTM + L/S(Internal) <b>6</b> + SPTM + L/S(External)

\*1 m20 adapter is attached to conduit entry

\*2 With hih-low temp and/or internal external SPTM, L/S option, positioner must be non-explosion type

# YT-100R BRACKET INSTALLATION MANUAL

